

SETTING TOOLS

SERIES MB 600/MB 700/MB 850 Setting Tool, mechanical

Material

Tool steel, Heat treated,
hardness approx. HRC 50

KOENIG-EXPANDER®

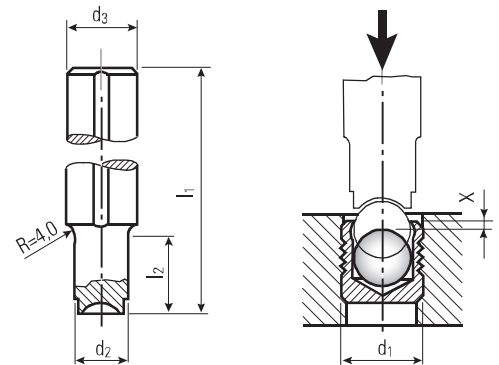

| Part Number | d ₁ Expander ∅ | d ₃ – h9 | l ₁ | d ₂ | l ₂ | x ±0.2 |
|-------------|---------------------------------|---------------------|----------------|----------------|----------------|-----------|
| MB 030 | 3,0 | 10 | 100 | 2,8 | 10 | 0,4 |
| MB 040 | 4,0 | 10 | 100 | 3,8 | 10 | 0,2 |
| MB 050 | 5,0 | 10 | 100 | 4,8 | 12 | 0,4 |
| MB 060 | 6,0 | 10 | 100 | 5,8 | 15 | 0,4 |
| MB 070 | 7,0 | 10 | 100 | 6,8 | 18 | 0,4 |
| MB 080 | 8,0 | 10 | 100 | 7,8 | 20 | 0,3 |
| MB 090 | 9,0 | 14 | 100 | 8,8 | 22 | 0,4 |
| MB 100 | 10,0 | 14 | 100 | 9,8 | 25 | 0,4 |
| MB 120 | 12,0 | 14 | 150 | 11,7 | 30 | 0,4 |
| MB 140 | 14,0 | 20 | 150 | 13,7 | 35 | 0,4 |
| MB 160 | 16,0 | 20 | 150 | 15,7 | 40 | 0,6 |
| MB 180 | 18,0 | 20 | 150 | 17,7 | 45 | 0,6 |
| MB 200 | 20,0 | 25 | 150 | 19,7 | 50 | 0,8 |
| MB 220 | 22,0 | 25 | 150 | 21,7 | 55 | 0,8 |

Dimensions in millimeters

North American customers please refer to page 36.